

90911



NEW ZEALAND QUALIFICATIONS AUTHORITY
MANA TOHU MĀTAURANGA O AOTEAROA

QUALIFY FOR THE FUTURE WORLD
KIA NOHO TAKATŪ KI TŌ ĀMUA AO!

1

SUPERVISOR'S USE ONLY

Level 1 Spanish, 2016

90911 Demonstrate understanding of a variety of Spanish texts on areas of most immediate relevance

2.00 p.m. Thursday 24 November 2016
Credits: Five

Achievement	Achievement with Merit	Achievement with Excellence
Demonstrate understanding of a variety of Spanish texts on areas of most immediate relevance.	Demonstrate clear understanding of a variety of Spanish texts on areas of most immediate relevance.	Demonstrate thorough understanding of a variety of Spanish texts on areas of most immediate relevance.

Check that the National Student Number (NSN) on your admission slip is the same as the number at the top of this page.

Pull out Resource Booklet 90911R from the centre of this booklet.

You should attempt ALL the questions in this booklet.

Answer each question in your choice of English, te reo Māori, and/or Spanish. If you need more room for any answer, use the extra space provided at the back of this booklet.

Check that this booklet has pages 2–11 in the correct order and that none of these pages is blank.

YOU MUST HAND THIS BOOKLET TO THE SUPERVISOR AT THE END OF THE EXAMINATION.

TOTAL

ASSESSOR'S USE ONLY

FIRST TEXT: *El mapa de Maxi/Maxi's map*

Read the text on page 2 of the resource booklet. Use it to answer Question One. Answer the question in your choice of English, te reo Māori, and/or Spanish.

QUESTION ONE

- (a) Use the information in the text to plot the following places on the map on page 3. Write the number of each place in the space where you think it is located. Number 1, and Maxi's house, have been done for you.

Usa la información del texto para poner los siguientes lugares en el mapa en la página 3. Escribe el número de cada lugar en el espacio donde piensas que se ubica. El número 1, y la casa de Maxi, están ya hechas.

- X Maxi's house. Start here / *La casa de Maxi. Comienza aquí.*
- 1. Maxi's grandmother's house / *La casa de la abuela de Maxi*
- 2. The school / *El instituto*
- 3. The gym / *El gimnasio*
- 4. Maxi's cousin's house / *La casa del primo de Maxi*
- 5. The supermarket / *El supermercado*
- 6. The park / *El parque*
- 7. The pool / *La piscina*
- 8. The bus station / *La estación de autobuses*
- 9. The restaurant / *El restaurante*

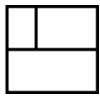
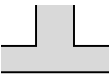
MAP KEY	
X	Maxi's house
1	Maxi's grandmother's house
	Buildings or outdoor areas, e.g. park
	Streets

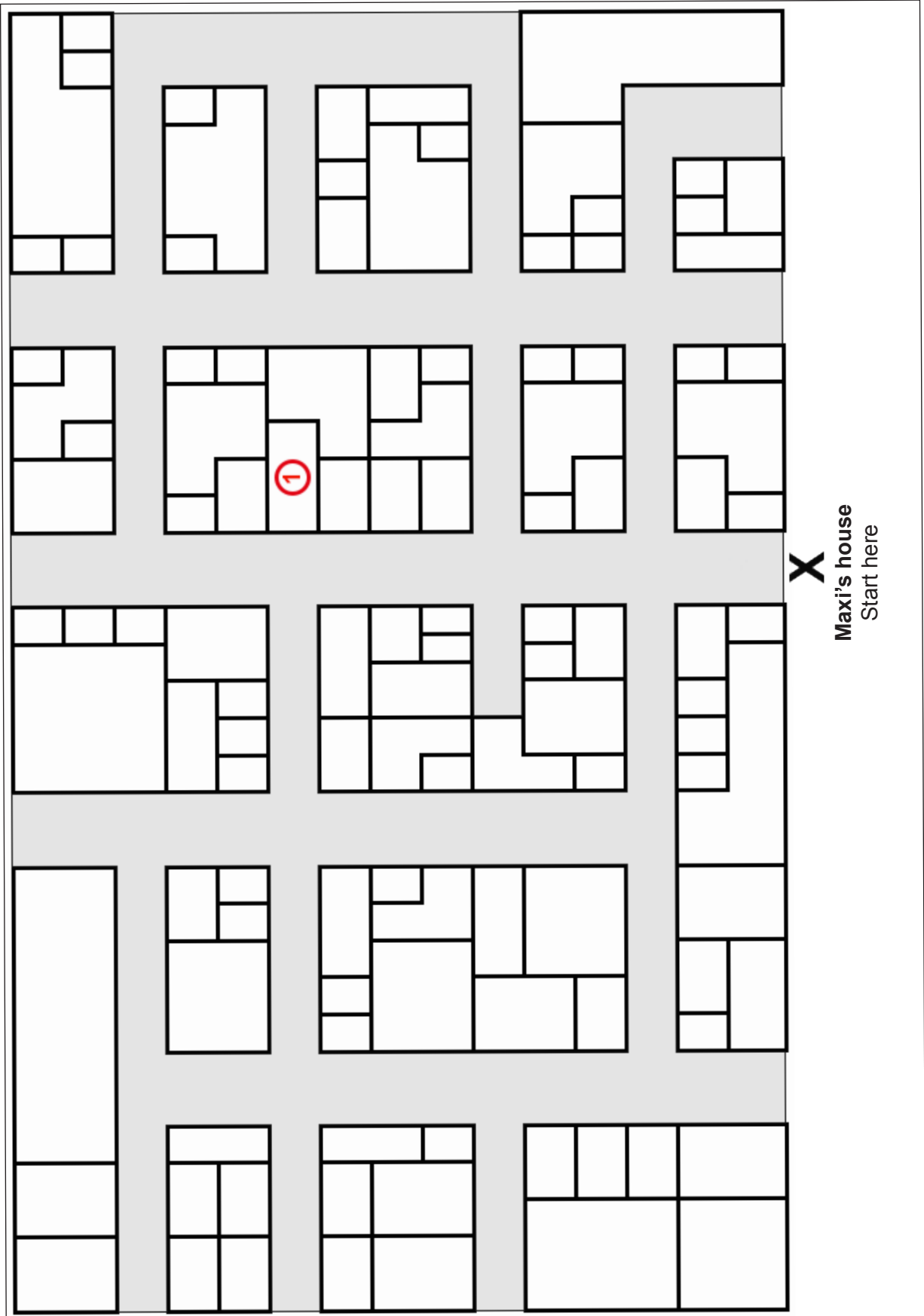

X
Maxi's house
Start here

**Question One continues
on the following page**

- (b) Why do you think Maxi lists each of these places as important for Harry? Justify your answer using details from the text.

¿Por qué piensas que Maxi dice que estos lugares son importantes para Harry? Justifica tu respuesta usando detalles del texto.

The school / *El instituto*: _____

The gym / *El gimnasio*: _____

Maxi's cousin's house / *La casa del primo de Maxi*: _____

The supermarket / *El supermercado*: _____

The park / *El parque*: _____

The pool / *La piscina*: _____

The bus station / *La estación de autobuses*: _____

The restaurant / *El restaurante*: _____

**This page has been deliberately left blank.
The examination continues on the following page.**

SECOND TEXT: *Celebraciones del Año Nuevo/New Year celebrations*ASSESSOR'S
USE ONLY

Read the text on page 3 of the resource booklet. Use it to answer Question Two. Answer the question in your choice of English, te reo Māori, and/or Spanish.

QUESTION TWO

- (a) How is the New Year celebrated in Spain? Base your answer on evidence from the text.
¿Cómo se celebra el Año Nuevo en España? Basa tu respuesta en información del texto.

- (b) When is Matariki, the Māori New Year, celebrated? Base your answer on evidence from the text.
¿Cuándo se celebra Matariki, el año nuevo Maorí? Basa tu respuesta en información del texto.

THIRD TEXT: *Programas de televisión para la familia*
Family television programmes

ASSESSOR'S
USE ONLY

Read the text on page 4 of the resource booklet. Use it to answer Question Three. Answer the question in your choice of English, te reo Māori, and/or Spanish.

QUESTION THREE

Choose the best TV show for each family to watch, based on their descriptions and the TV guide. Give details about the show, and explain why it is the best choice for that family.

Elige el mejor programa para ver para cada familia basándote en sus descripciones y la guía de televisión. Da detalles del programa, y explica por qué es la mejor opción para esa familia.

(1) **Familia González**

TV show / Programa: _____

Reasons for your choice / Razones de tu elección: _____

90911