

This assessment is based on a now-expired version of the achievement standard and may not accurately reflect the content and practice of external assessments developed for 2024 onwards. No part of the candidate's evidence in this exemplar material may be presented in an external assessment for the purpose of gaining an NZQA qualification or award.



Mana Tohu Mātauranga o Aotearoa
New Zealand Qualifications Authority

Level 1 Design and Visual Communication RAS 2023

**92003 Use instrumental drawing techniques
to communicate own product or spatial design
outcome**

EXEMPLAR

Achievement

TOTAL 03

PLANNING PAGE
IF YOU DON'T KNOW HOW TO BRING IT THAT LIKE BUTTON

TOP VIEW

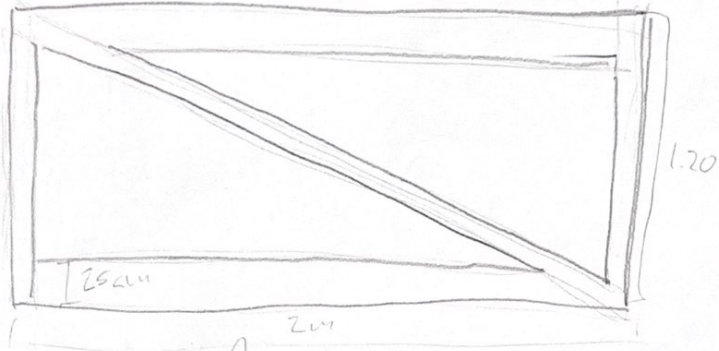

BOTTOM VIEW

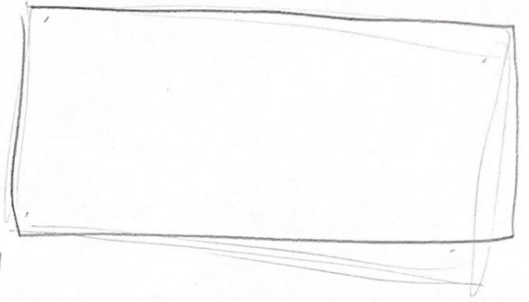

LEFT

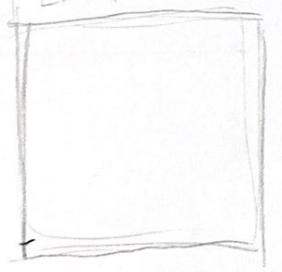

SIDE VIEW

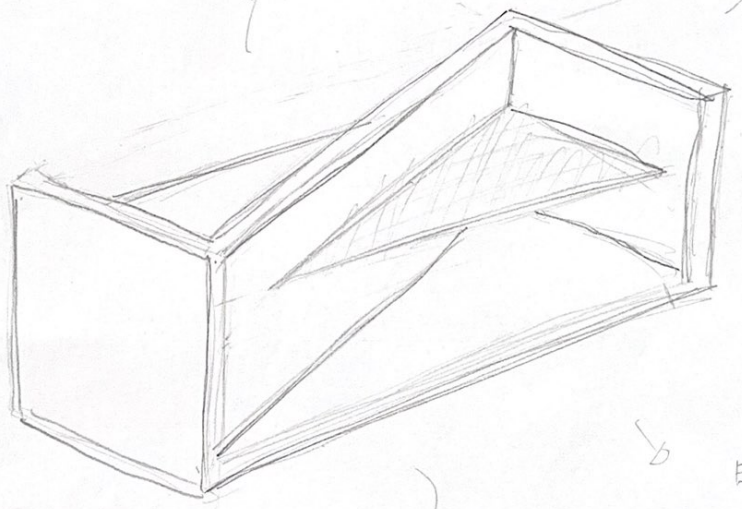

RIGHT

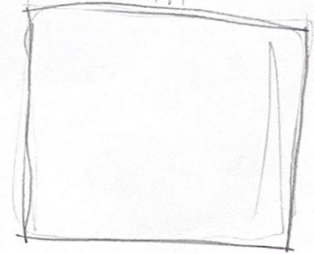

FRONT VIEW

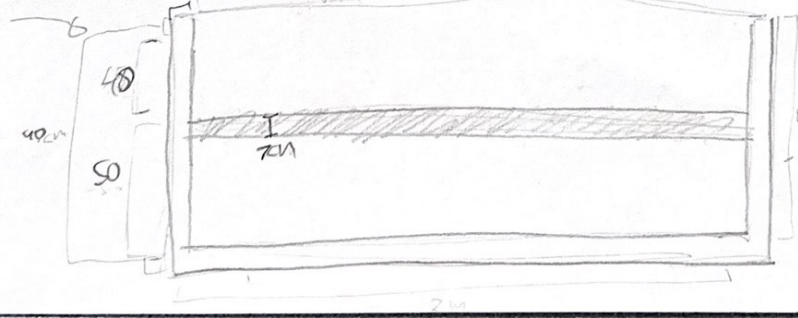

EXPLODED

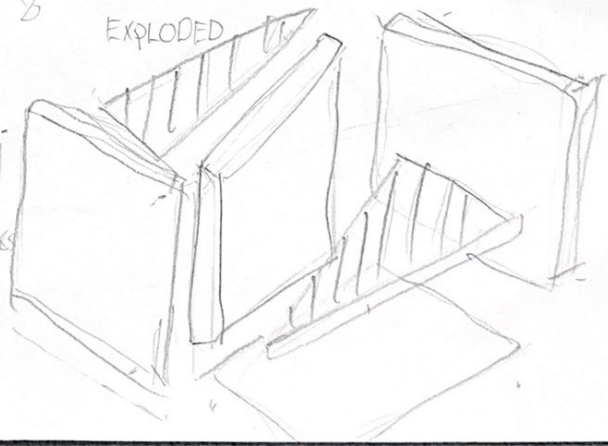

MEASUREMENTS
300mm - BACKREST
450mm - SEAT HEIGHT
70mm - WIDTH BRICK
200mm - LENGTH

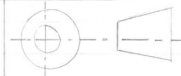
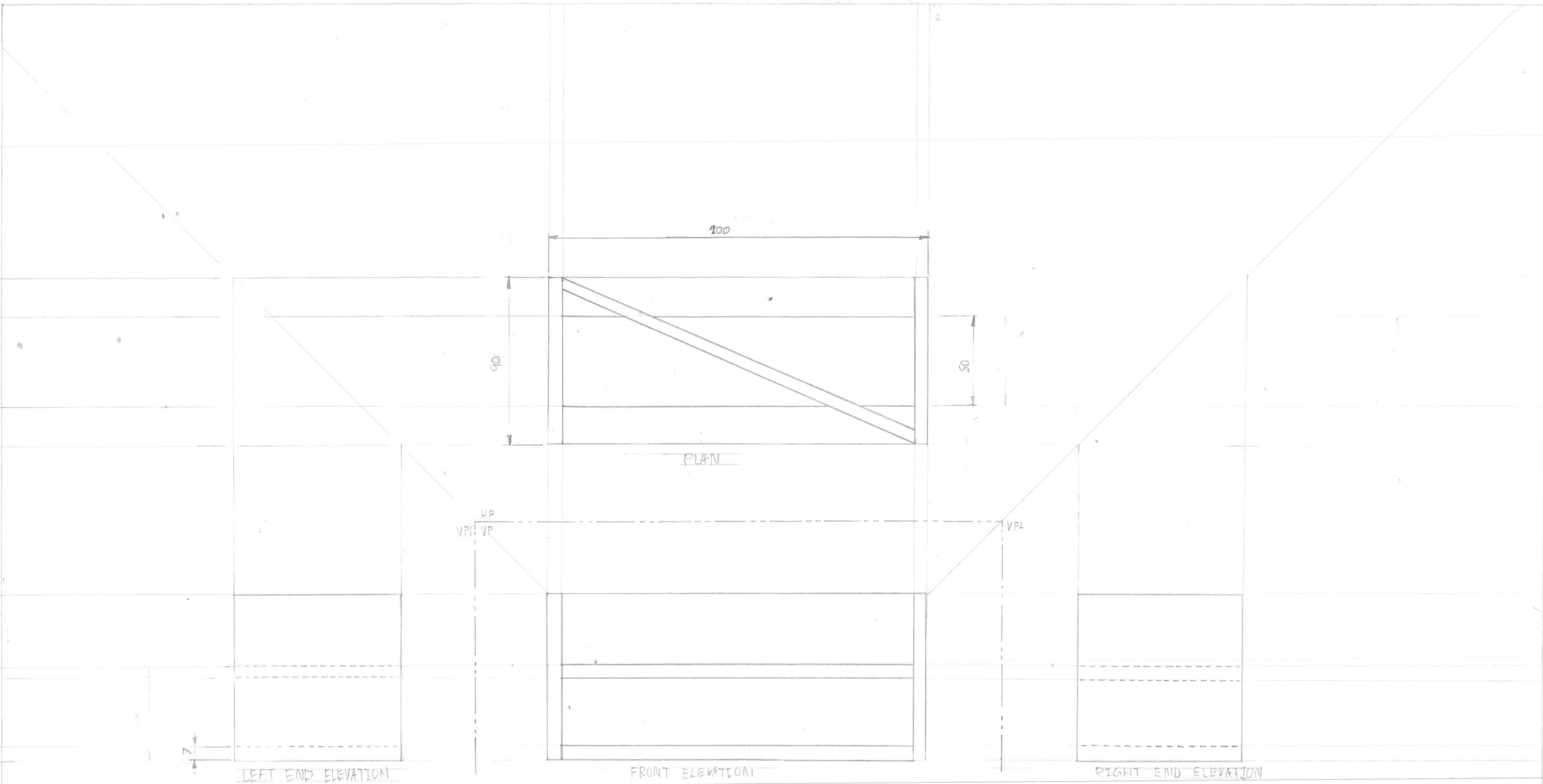

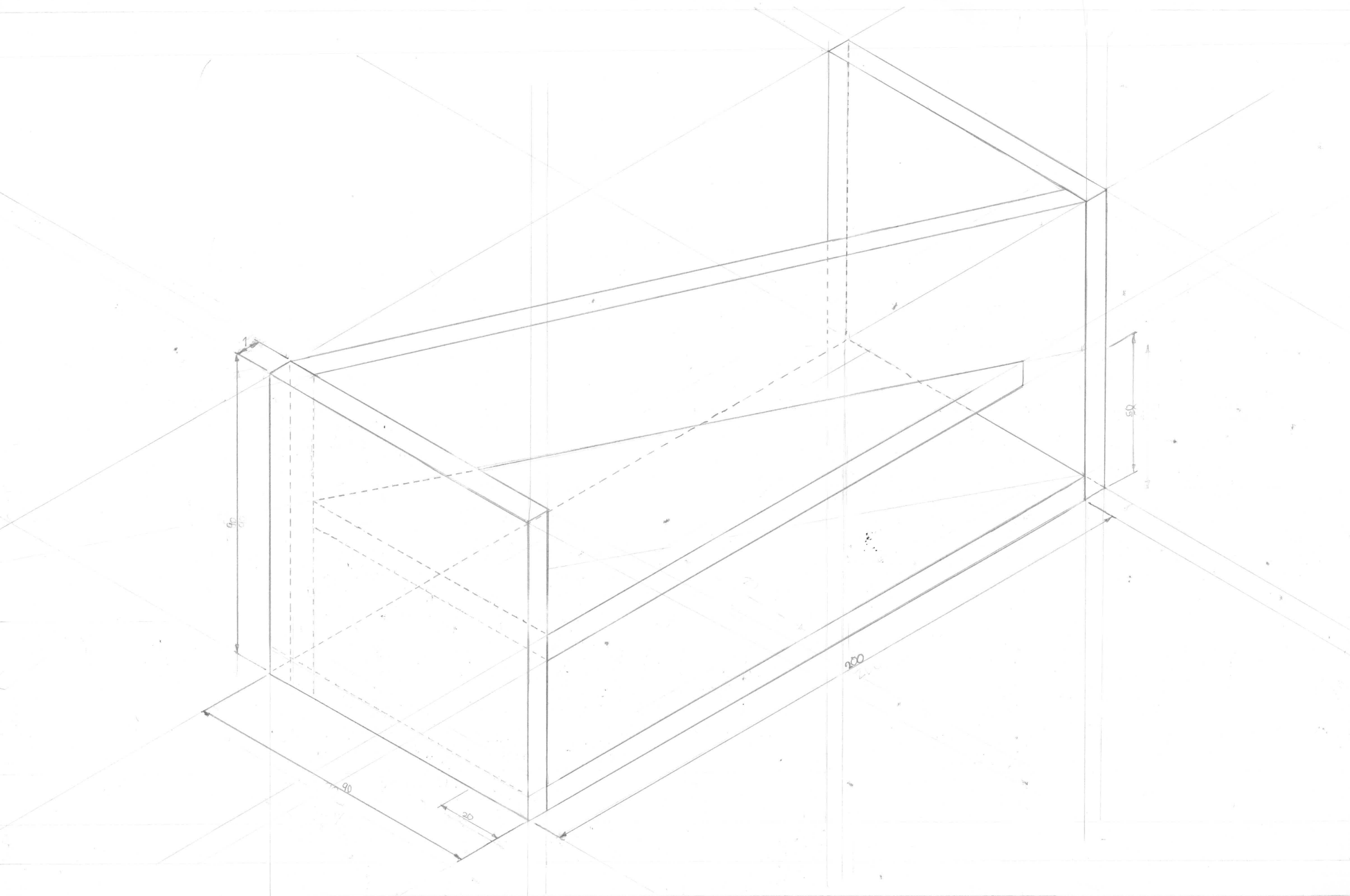

TITLE: ISOMETRIC PARALINE	SCALE: 1:10	ALL MEASUREMENTS IN MILLIMETERS	2 of 3
---------------------------	-------------	---------------------------------	--------

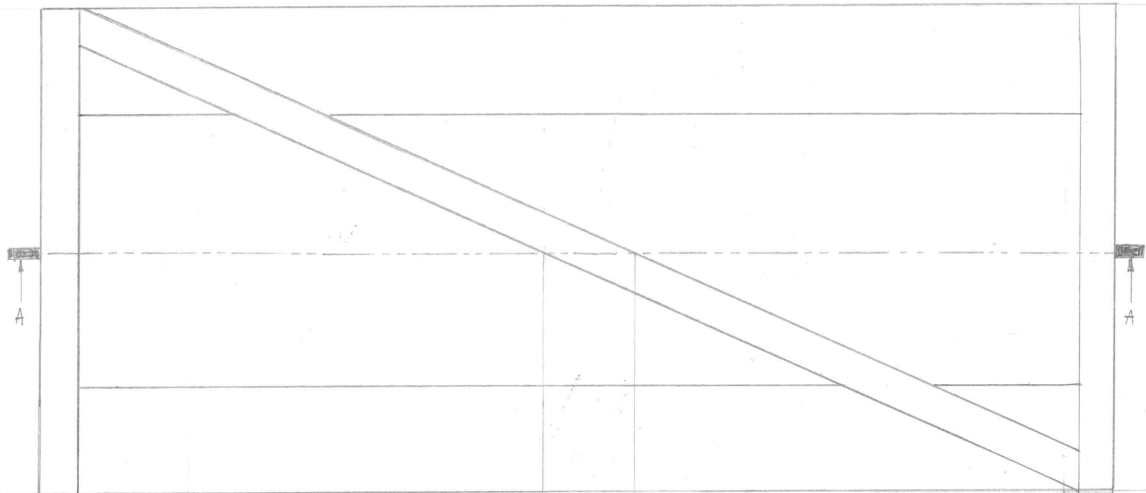

PLAN VIEW

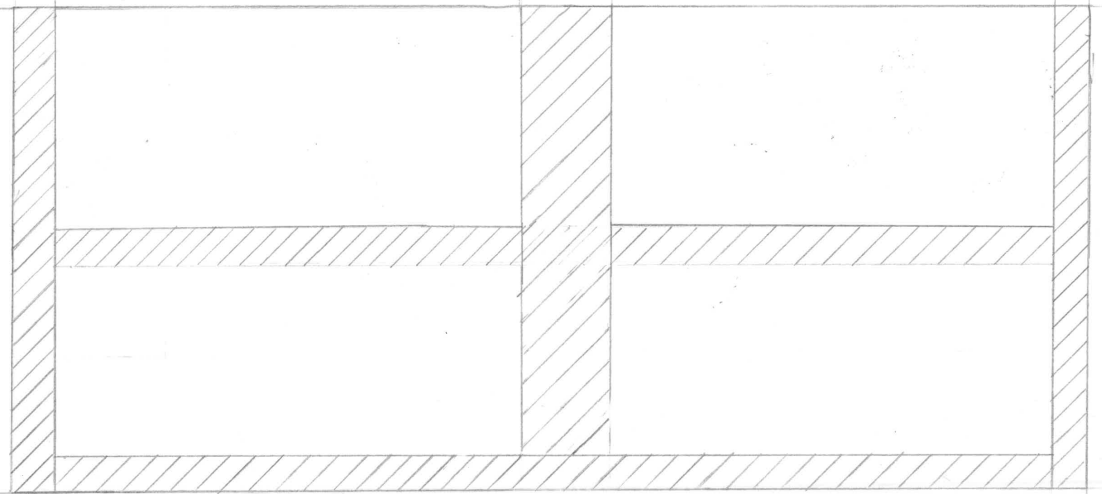

SECTION AA

Achievement

Subject: Design and Visual Communication

Standard: 92003

Total score: 03

Grade score	Marker commentary
A3	<p>This submission begins by showing some planning sketches for the design and its details. It would be helpful if the submission used a title on the planning page and on the drawings to indicate what the design is, e.g. Outdoor Seat.</p> <p>Orthographic views and an isometric drawing have been constructed manually and clearly show the form and surface features of the outcome. The orthographic views are well drawn using a scale. Main dimensions have been added but with incorrect measurements, using the scaled measurements rather than the real-life dimensions. Hidden detail lines have been used correctly but only show surface features. No internal detail of construction or assembly has been shown. The second page shows a section view that, while correctly drawn, does not reveal further information.</p> <p>The isometric drawing also shows neatly drawn form and surface features. Once again, the dimensions do not give the correct measurements and no construction information is shown.</p>

This assessment is based on a now-expired version of the achievement standard and may not accurately reflect the content and practice of external assessments developed for 2024 onwards. No part of the candidate's evidence in this exemplar material may be presented in an external assessment for the purpose of gaining an NZQA qualification or award.



Mana Tohu Mātauranga o Aotearoa
New Zealand Qualifications Authority

Level 1 Design and Visual Communication RAS 2023

**92003 Use instrumental drawing techniques
to communicate own product or spatial design
outcome**

EXEMPLAR

Achievement

TOTAL 03

Summary page

I designed the chair to seat two people

Comfortable seat with backrest

comfortable reclining chair

I choose plastic to make the chair, so the chair can be easily bent

The chair also has armrests, which I designed to have a curve and stretch down. make it easier for you to put your hand on

The armrests are glued to the chair

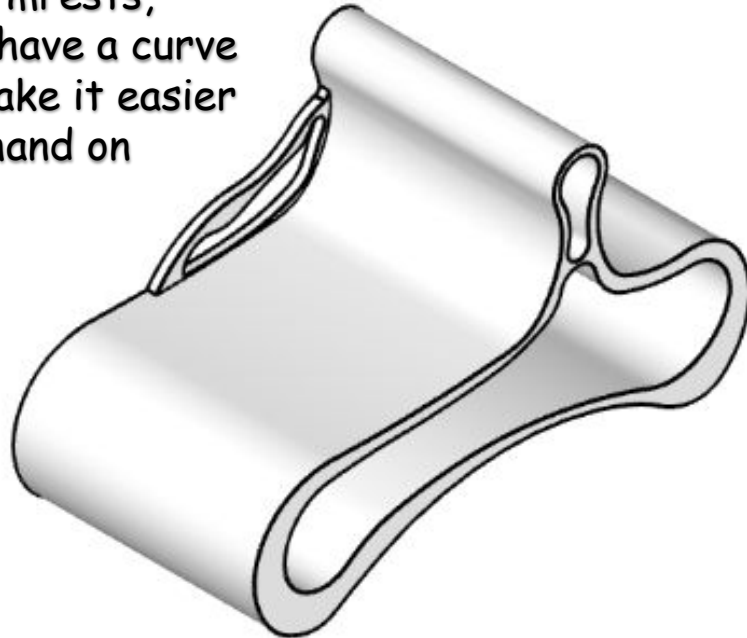
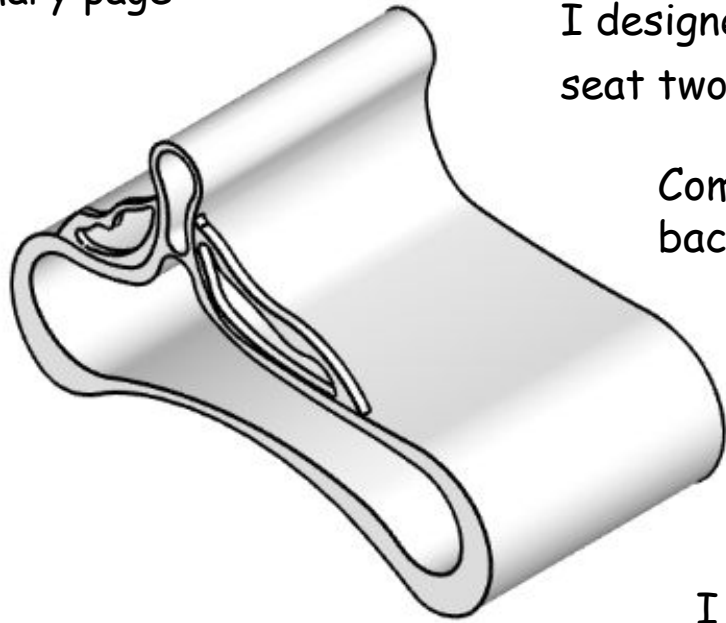

Kindergarten in Dong Nai, Viet Nam

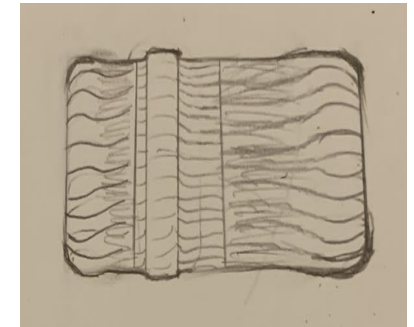
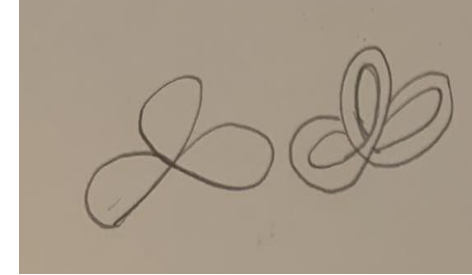
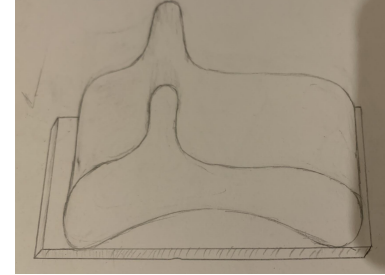

Orthographic drawings

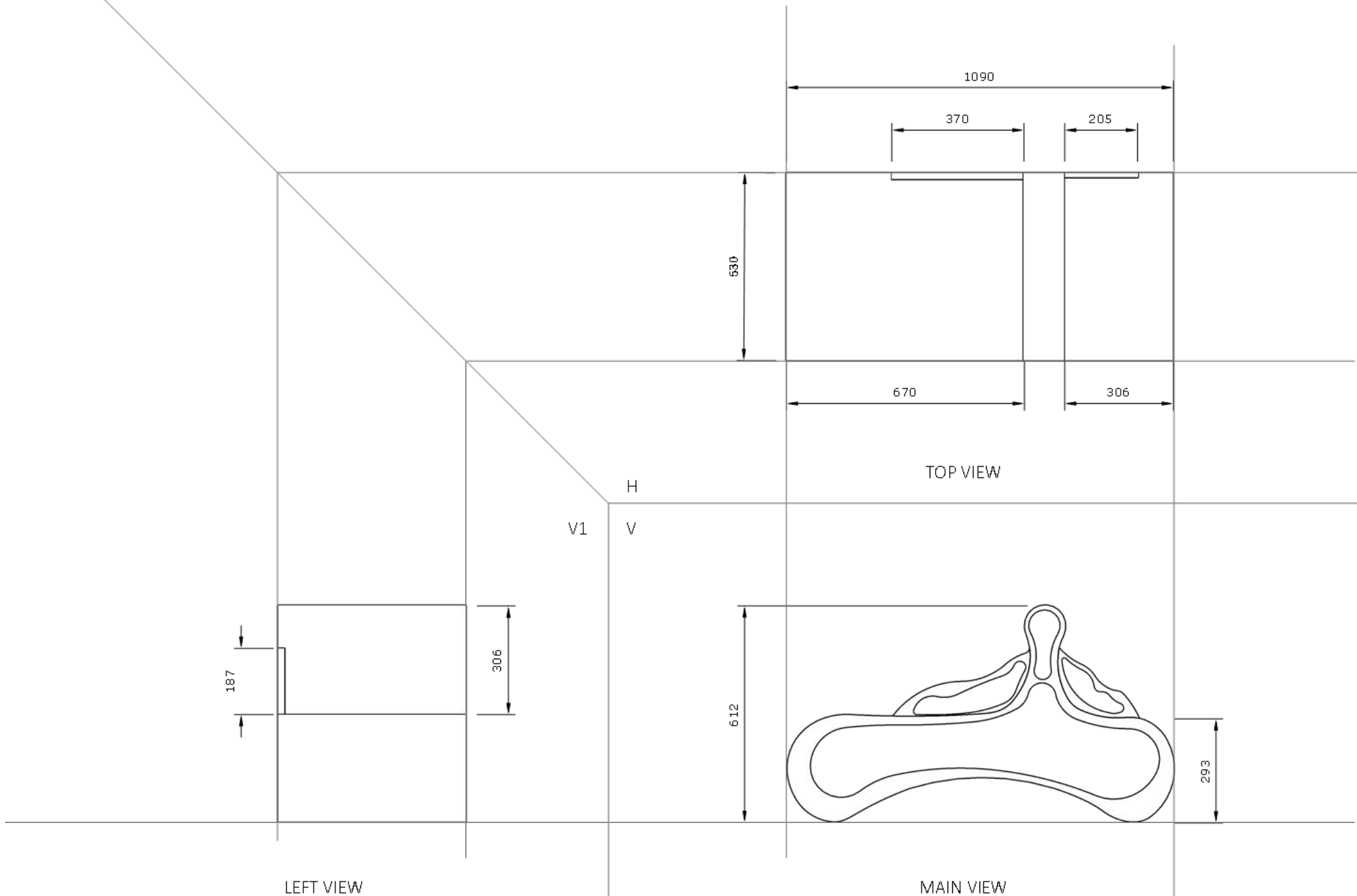

SCALE 1:10

OUTDOOR CHAIR ORTHOGRAPHIC DRAWING

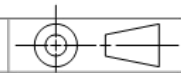

Exploded and assembled isometric

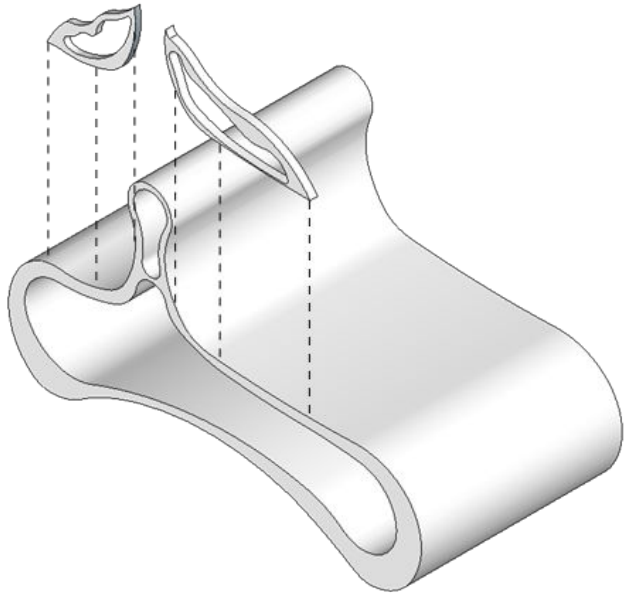

Exploded and assembled isometric - 1:10

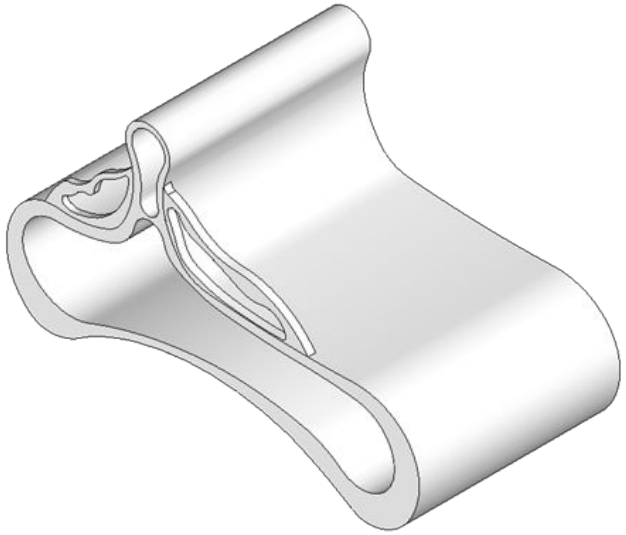

Assembled Isometric: Scale - 1:10

Exploded and assembled isometric - 1:10

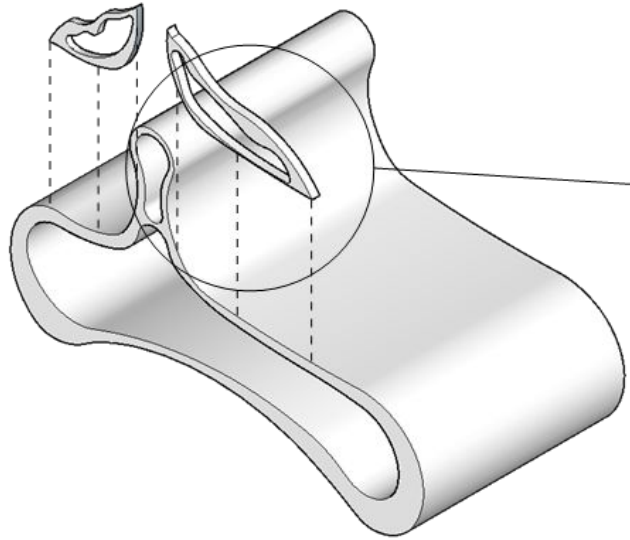

Exploded and assembled isometric - 1:2

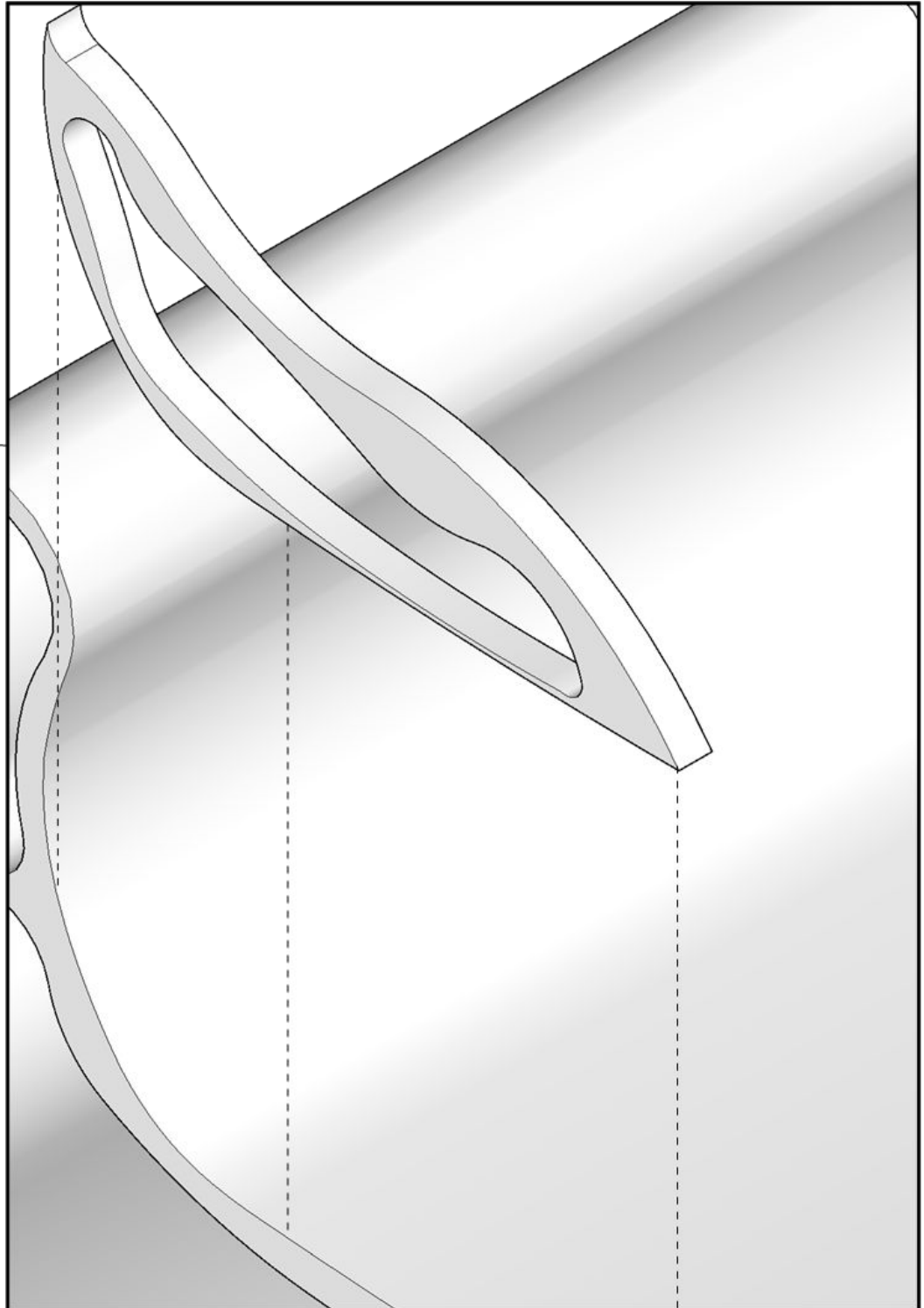

Achievement

Subject: Design and Visual Communication

Standard: 92003

Total score: 03

Grade score	Marker commentary
A3	<p>This submission begins with planning work that clearly shows that the outcome being presented is a chair. An orthographic drawing and paraline drawings have been produced using CAD.</p> <p>The orthographic drawing uses a scale correctly to produce three projected and correctly aligned views. Projection lines have been added but, unfortunately, make the drawing difficult to read. It would be clearer to not include the projection lines. The views show the form and surface features of the chair and include the main dimensions. No hidden detail is shown.</p> <p>A number of isometric paraline drawings show the form of the chair and give some information about parts. However, these drawings still only show surface features and there is no internal detail or indication of how the parts are held together.</p>