

No part of the candidate's evidence in this exemplar material may be presented in an external assessment for the purpose of gaining an NZQA qualification or award.



Level 1 Design and Visual Communication 2025

**92002 Develop product or spatial design ideas
informed by the consideration of people**

EXEMPLAR

Achievement

TOTAL 03

DVC - Staff Courtyard Furniture Design

Specifications

- Your furniture and layout design must fit within the existing courtyard space
- You can not block the existing entrances to the staffroom from the courtyard, however you can change the doorways from the rest of the school into the courtyard if necessary
- Include comfortable seating space for at least 14 staff
- Must include one piece of furniture that defines the space and makes a visual statement

The Brief: The [redacted] High School staffroom and courtyard is outdated and no longer fit for purpose. The Board of Trustees has approached you and asked that you redesign the courtyard space with a particular focus on custom-designed outdoor furniture which will ensure a relaxing space for staff to eat their lunch.



Some images of the space we are working with



Survey results

How often do you use the courtyard outside the staffroom?
41 responses

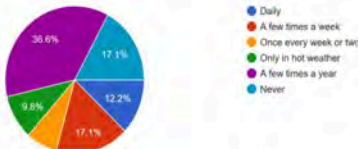

This information helps us know how often the courtyard gets used to see if a redesign is worth it.

if the courtyard were more comfortable, up-to-date and user-friendly would you use it more frequently?
41 responses



This graph lets us know that if the courtyard were to be redesigned and up to date more people would use it.

How do you use the courtyard currently?
40 responses

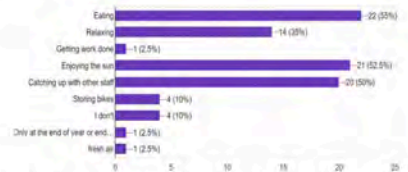

This graph helps us understand what people use it for.

What kind of seating do you like in a courtyard?
40 responses

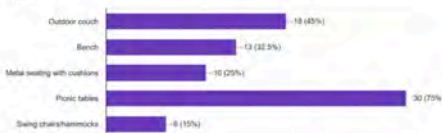

This graph helps us understand what kind of seating the staff would like to see in the courtyard.

Do you prefer individual chairs or group seating?
40 responses

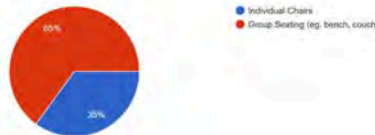

This graph lets us know that a lot of the staff would rather group seating than individual seating.

What type of tables would you use in a courtyard?
40 responses

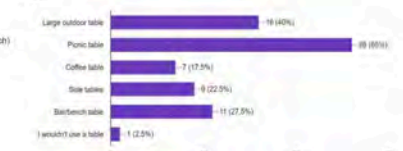

This information helps us understand what kind of seating the staff would like to see in the courtyard.

What is important for you to have environmentally in the space?
40 responses



This graph lets us know that the courtyard should have sunlight and a blocked view from students.

Which 'optional extras' would you appreciate having in the courtyard?
40 responses

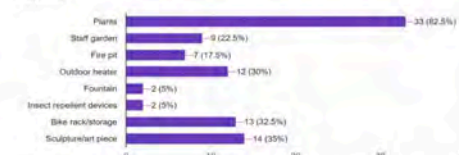

This graph tells us that most staff would like to see more plants.

Which surface conditions do you prefer?
40 responses



The graph tells us that most staff wants to see decking and pavers.

aesthetic and functional attributes of photos



This design is only for aesthetic purposes with very little functional purposes by adding more seating and a table it could easily be turned into a functional courtyard.

positives: lots of room

negitives: not alot of seating and no tables

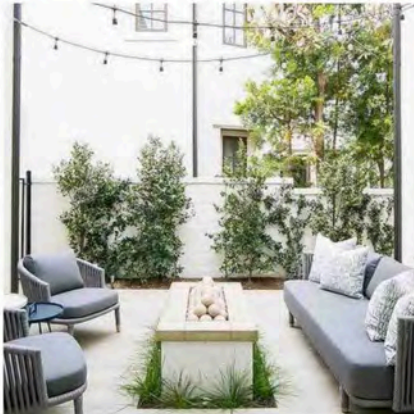

This design is very functional with many functional factors like a table, seating and lights but this functional design is also aesthetic because of the trees, grass and the colour coordination.

positives: lots of seating a table and nice scenery

negitives: not alot of room



Site analysis

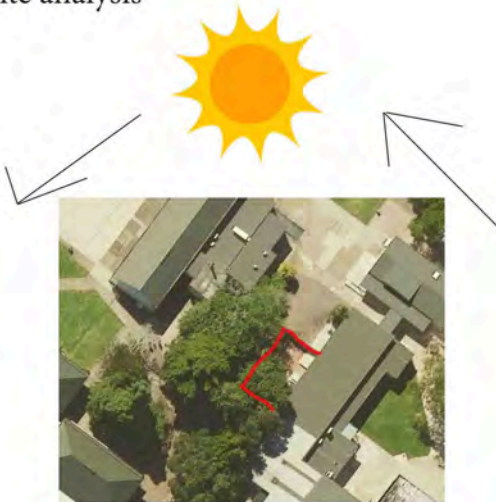

The staff courtyard is old and outdated and remodeling the place might bring more people to use it, the position that the staff courtyard is in is good for sunlight, in the morning some benches will receive sun light and some will have shade giving people an option on what they prefer, lunch time the sun will be beaming down onto the courtyard giving most the courtyard some sun. In the afternoon the whole courtyard will be receiving light from the sun. The courtyard also has 3 entrances making it less crowded when everyone.

Ideation page 1

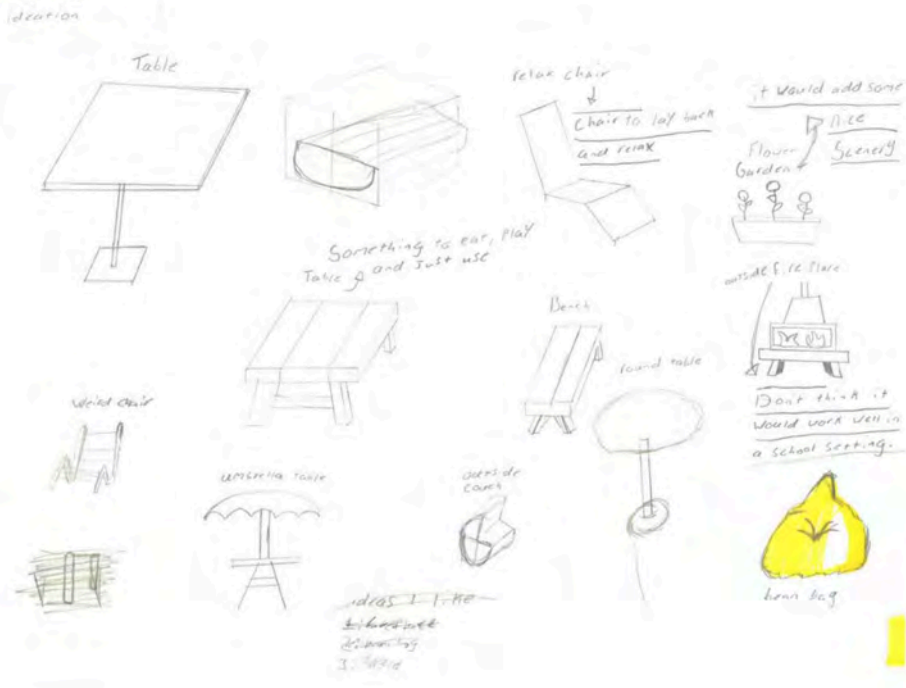

Ideation page 2

Reading staff feedback i learned that they majority of the staff wanted a picnic table and grouped seating so that influenced me to make a picnic table design that would suit this feedback.

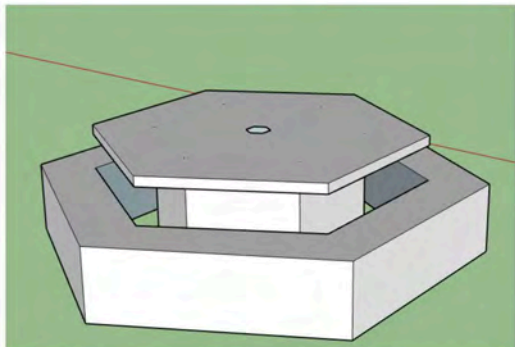
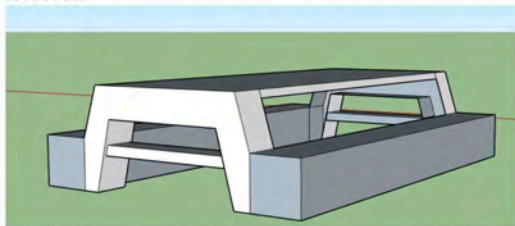

using feedback i learned that 75% of staff wanted a picnic table and 65% of staff wanted grouped seating so i made simple round table and chair setup that can fit many people, it would also fit well in the courtyard.

Looking at the feedback i saw that just under half of staff wants a type of seating that only fits 1 person

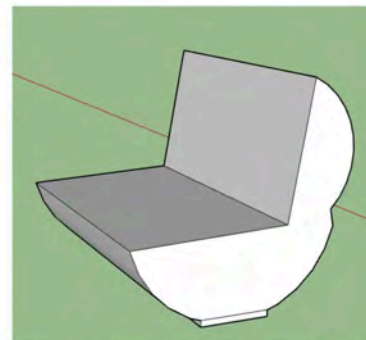
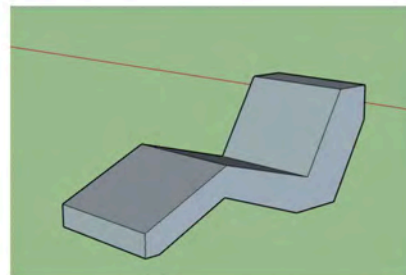

Using feedback i learned that 35% of people want a seat that is not grouped so i made this to fit that feedback.

Concept page 1

Concept Page



I have chosen this design because I think I can expand the idea and make it more functional



this design is very functional when it comes to weather protection and it still provides the comfort of a beanbag



This design gives the beanbag a cover protecting it from any harsh weather conditions this design has nothing to protect the top



This is the design I want to continue because it adds all the features together to make the perfect functional and aesthetic beanbag



This design also has weather protection but its square

Concept page 2

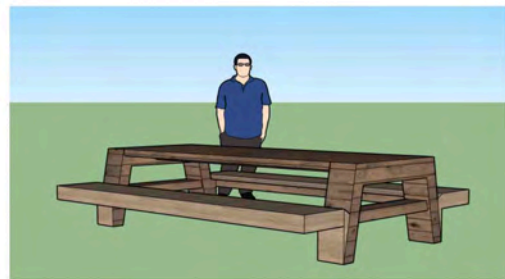
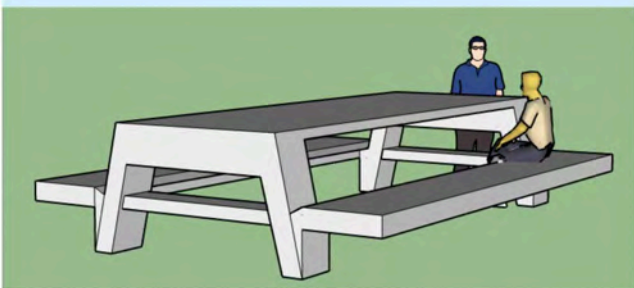
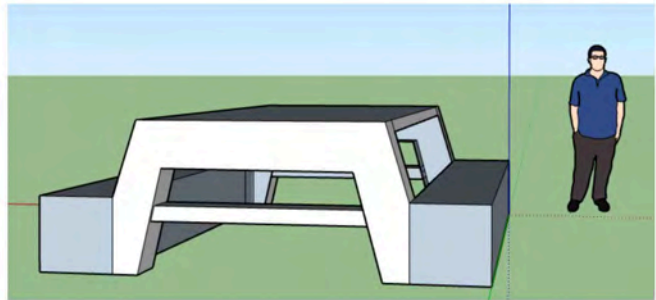
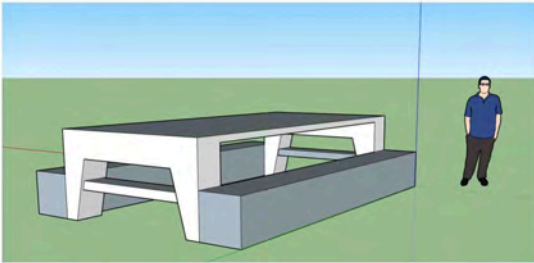

I choose a table design because I think it would work really well in a staff courtyard and it would replace the old tables with new clean tables. The first design of the table was very blocky, basic and not comfortable for users to sit in, the second table I started to round the table by making the top be angled helping users get in and out of the table with a little more ease. The third design of the table, I got rid of the blocky look making it more aesthetically pleasing and more functional making users easily be able to get in and out of the table, the final design I just resized the table to a human size table and gave it some texture for aesthetic purposes and so it would look nice in the staff courtyard.

Ergonomics page

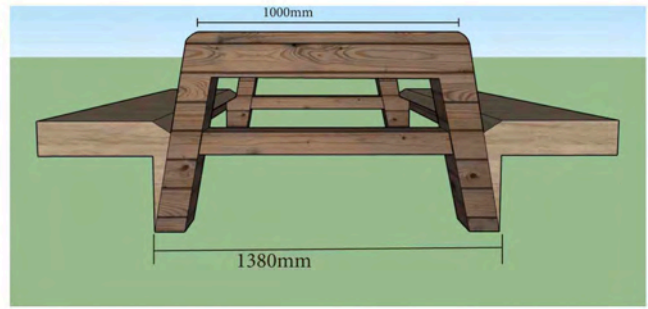
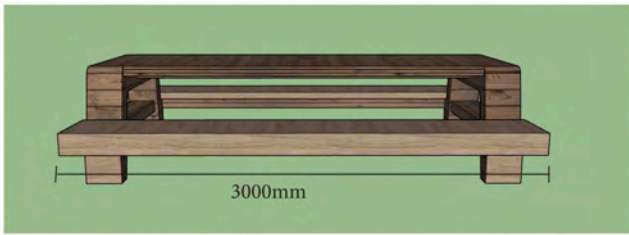

Added soft curves on the table-top to make it safer and more comfortable



Made it more spacious were your legs are when sitting at the table

Aesthetic and material development



Oak wood is really durable and is very strong, it also looks aesthetic but it comes with the downside of being heavy and costing a lot more than other woods.

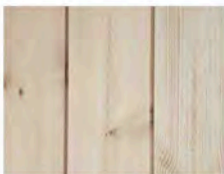

Pine wood is affordable and lightweight however it comes with negatives like it damages from moisture and insects another negative is that its a very soft wood making it vulnerable to physical damage.

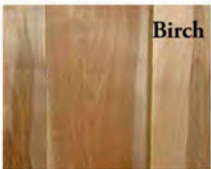

Birch

Birch wood is cheaper, durable and strong its also very smooth and has a good aesthetic but the negatives of birch wood is that its vulnerable to rotting and insects without proper treatment

Ive decided to go with oak because its got a classic aesthetic, although it costs more, in the long run oak will be more worth it because it requires less upkeep than oak or pine would need.



This design of the seat makes it more minimal and adds some aesthetic to the seat. But reduces strength.



This is the original version and it probably the most reliable and sturdy.

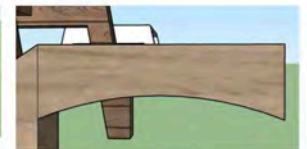

This version of the seat is a little more interesting both aesthetically and functionaly, it may be more aesthetically pleasing to some more than others but it reduces the strength of the seat.



Courtyard layout

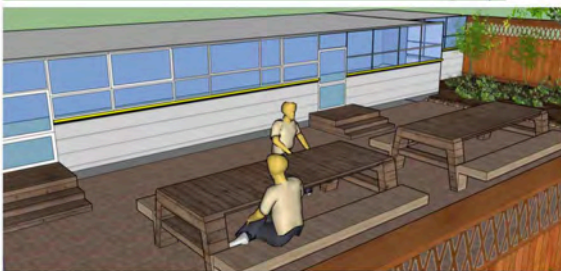
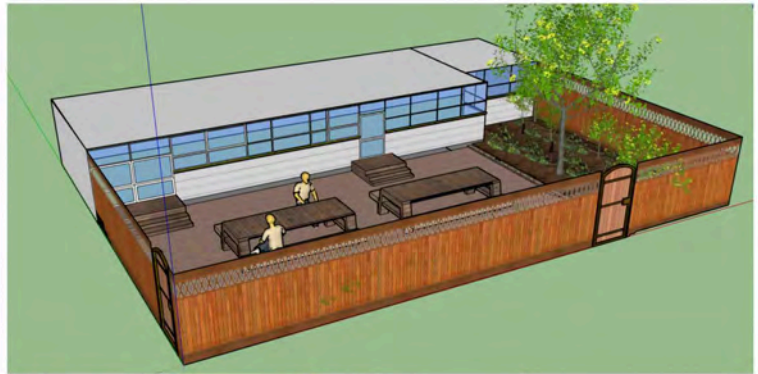
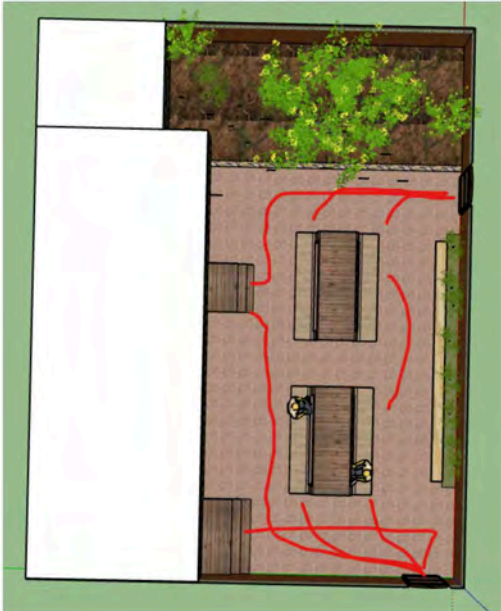

This layout of tables is very good because as shown in the first image the pathways that you can follow to get to your desired destination and as you can see from the image that shows pathways that you can take to go where you need to go to and when looking at the image you can see that the pathways are very efficient and almost like the tables aren't there. This layout can also fit 14 people and still be efficient.

Evaluation

Specifications

The furniture and layout design must fit within the existing courtyard space

You can not block the existing entrances to the staffroom from the courtyard, however you can change the doorways from the rest of the school into the courtyard if necessary

Include comfortable seating space for at least 14 staff

Must include one piece of furniture that defines the space and makes a visual statement
furniture must be weather resistant

I met all the specifications by making a picnic like table that fit well into the courtyard and wasn't too big or too small and made sure that the tables were perfectly placed in the middle of the courtyard so that it blocks no exits/entrances and people can still pathfind their way around the courtyard, the tables are somewhat comfortable based on the wood that I chose and can fit 14 staff if needed.

Client feedback

1. Do you think this table would work well and look nice in the staff courtyard?
2. What would you change about the way this design looks?
3. What would you change about how this design works functionally for staff wanting to sit and eat in the courtyard (ie. comfort, usability)?
4. Is there anything else you think I could improve when designing a table and chair set for the staff courtyard?

Answers.

1. yes I think it would look nice and be a very functional table
2. I would soften some of the hard corners for safer reasons and comfort
3. maybe put an umbrella holder in the middle so its still functional when raining
4. other than the umbrella and softening the curves for safety I think its a good design and would work well.

Aesthetic + functional features

when making the table I thought about how I can make the design more aesthetic and functional so I decided to curve a lot of the corners on the table for a safer more minimal table design and cut out and soften certain parts of the table to make it easier to get in and out of the table and more comfortable and made the table a good size so that everyone can sit at it and it fits the courtyard well.

Achievement

Subject: Design and Visual Communication

Standard: 92002

Total score: 03

Marker commentary

This submission uses the redesign of a staff seating area at a school as the design context and the work clearly relates to this context.

A range of design ideas have been generated using both freehand sketches and SketchUp. An attempt has been made to include people in some of the ideas.

The submission shows one very small change to the design – the shape of the seat changing from blocky to slimmer. This change is not enough to be considered “progression through a visual sequence or journey” as is required for Merit. The change is not evident in the final design, which shows the original SketchUp design rather than the changed design.

Multiple angles of the design have been shown, and the final design is shown in the intended courtyard, with people using the final outcome.

The design decisions made in the work would be more convincing if people, context, and site had been visually communicated more in the development pages.

Pages 2, 3 and 12 of this submission are not directly relevant to this standard and did not need to be included in the submission.